

XTOOL

Chiosco Self-Service da Pavimento

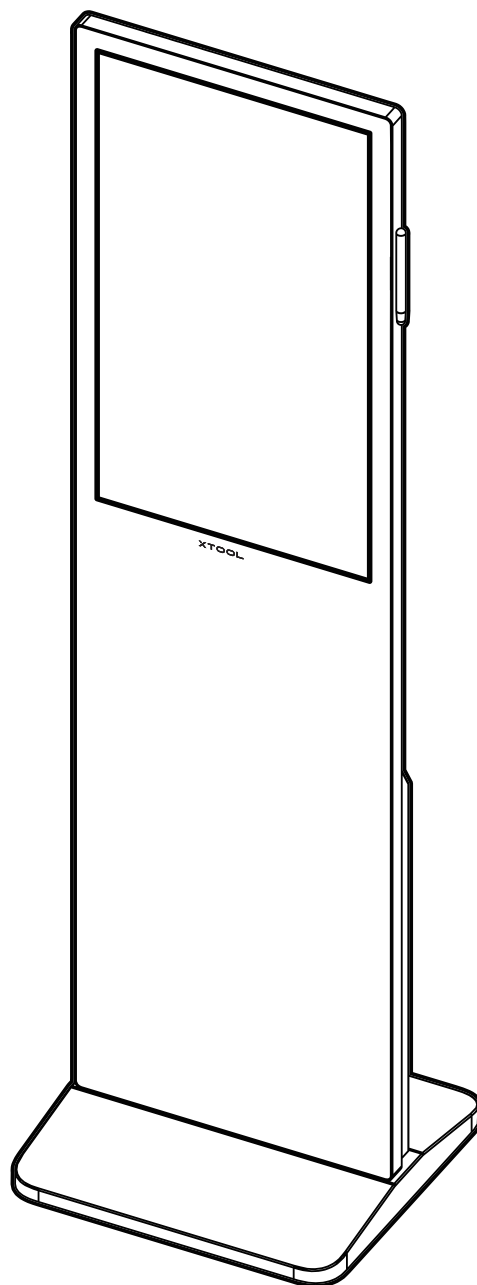

Guida rapida

Elenco degli articoli · - - - - - 01

**Conoscere xTool Chiosco
Self-Service da Pavimento** · - - - - - 02

**Installare xTool Chiosco Self-Service
da Pavimento** - - - - - 04

**Usare xTool Chiosco Self-Service
da Pavimento** - - - - - 06

Elenco degli articoli

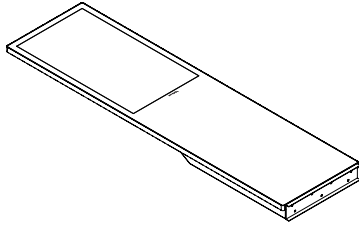

Chiosco self-service

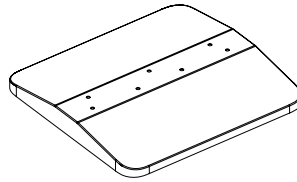

Base di supporto

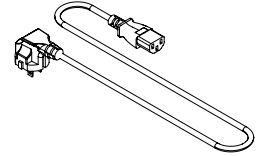

Cavo di alimentazione

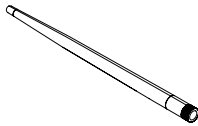

Antenna

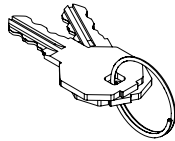

Chiave di manutenzione

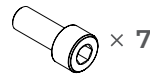

Vite

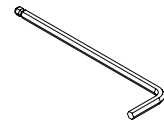

Chiave esagonale da

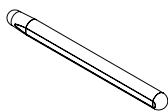

Penna stilo



Guida rapida

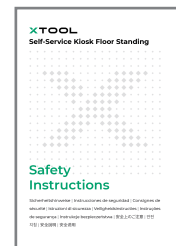

Istruzioni di sicurezza



Il cavo di alimentazione varia a seconda della regione in cui il prodotto viene fornito.

Conoscere xTool Chiosco Self-Service da Pavimento

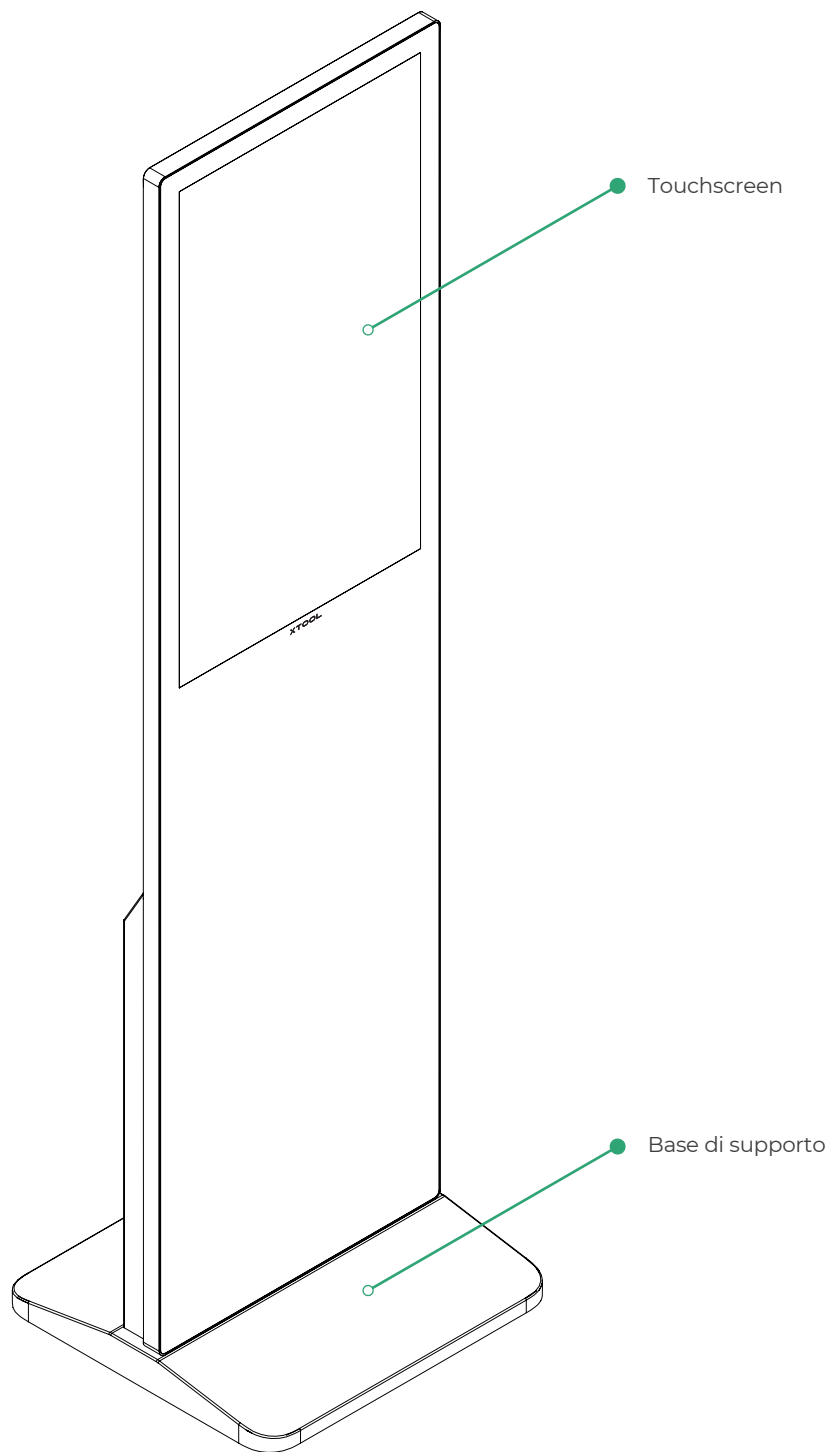

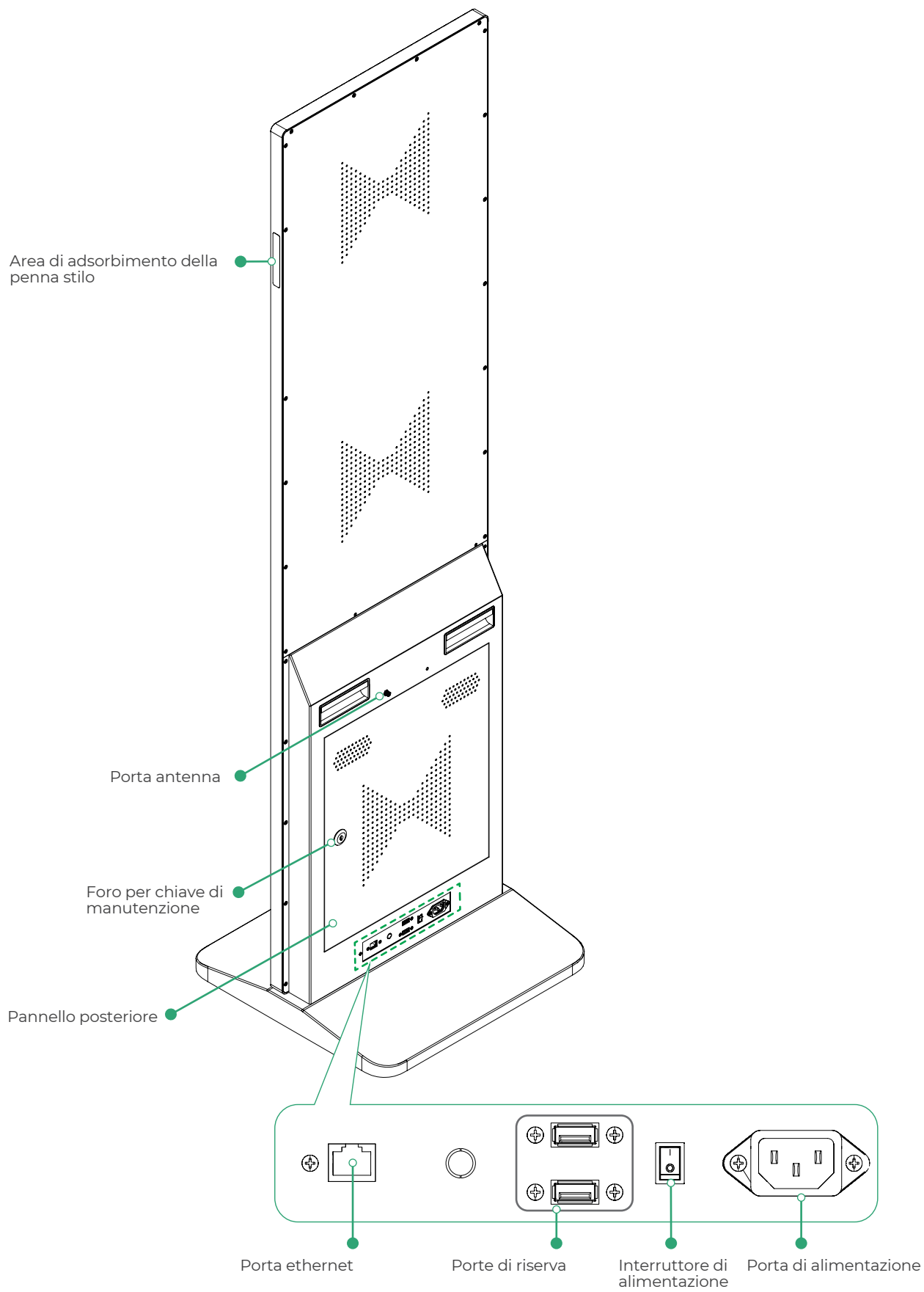

 Il pannello posteriore può essere aperto solo utilizzando la chiave di manutenzione durante la riparazione.

Installare xTool Chiosco Self-Service da Pavimento

1 Installare la base di supporto

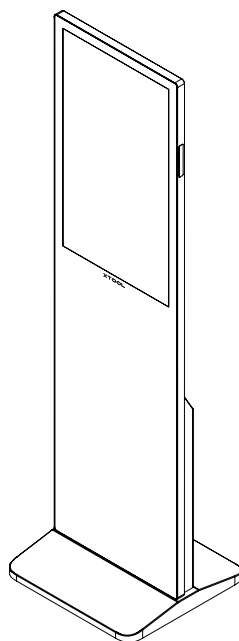
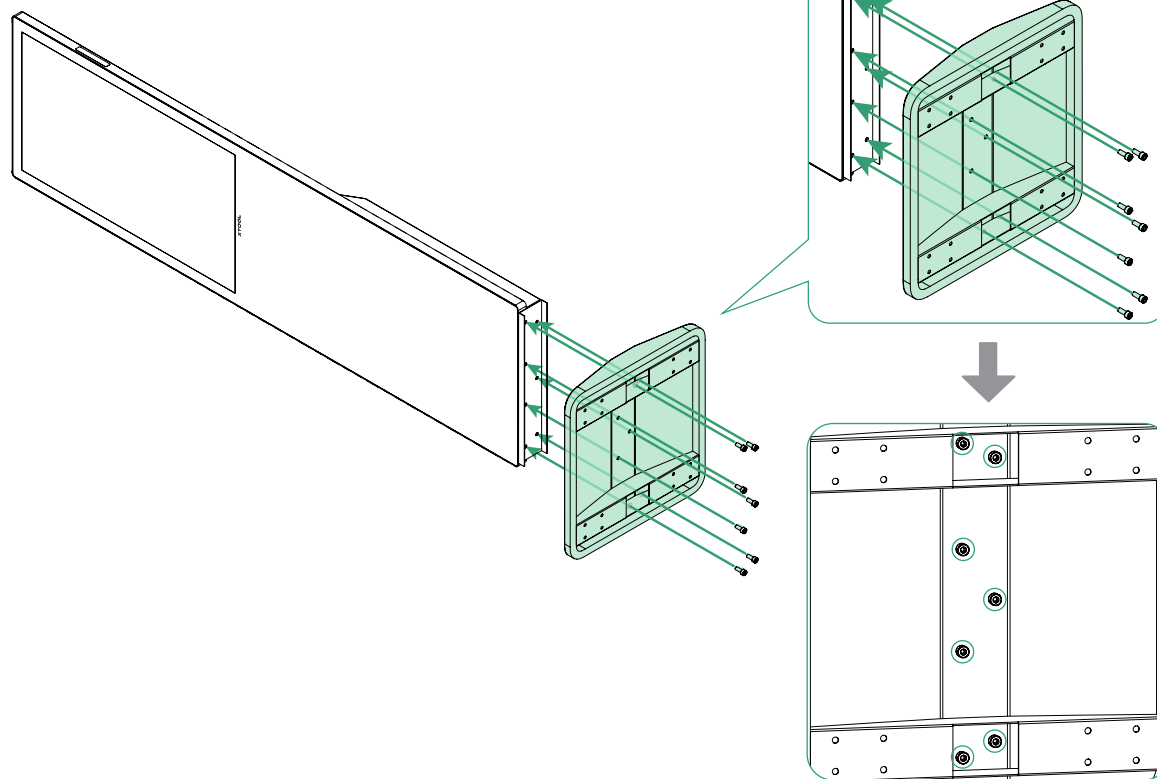
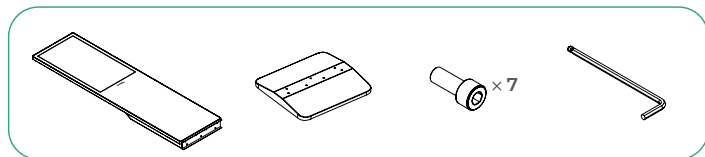

2 Installare l'antenna

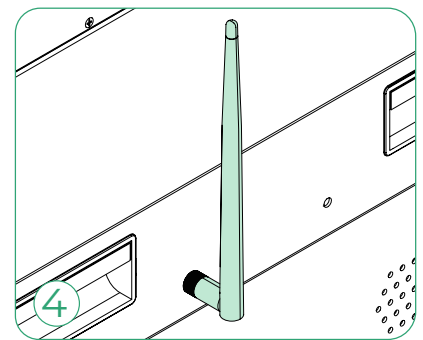
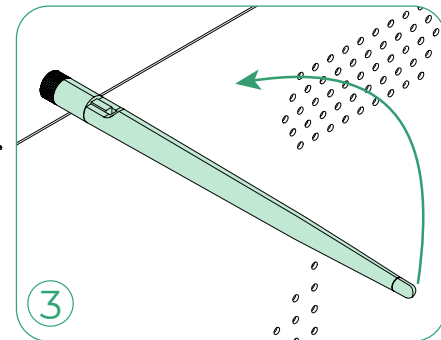
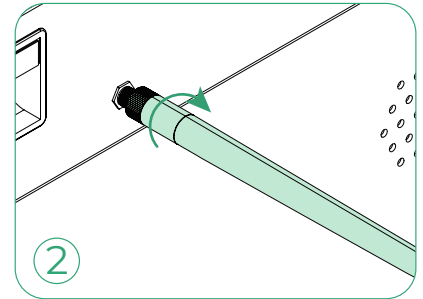
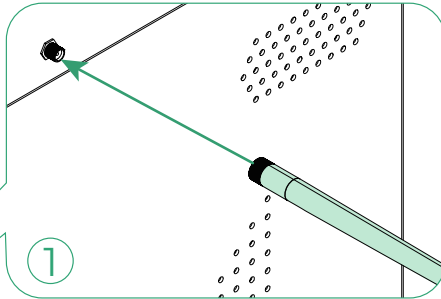
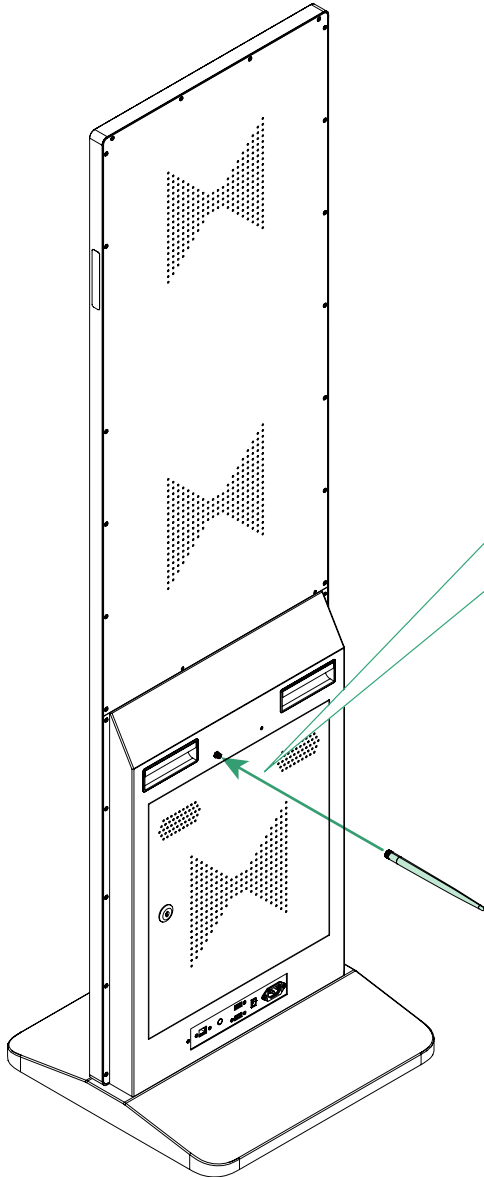
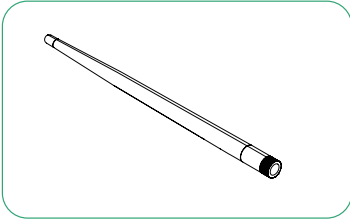

Usare xTool Chiosco Self-Service da Pavimento

Inserire il cavo di alimentazione e accendere il chiosco

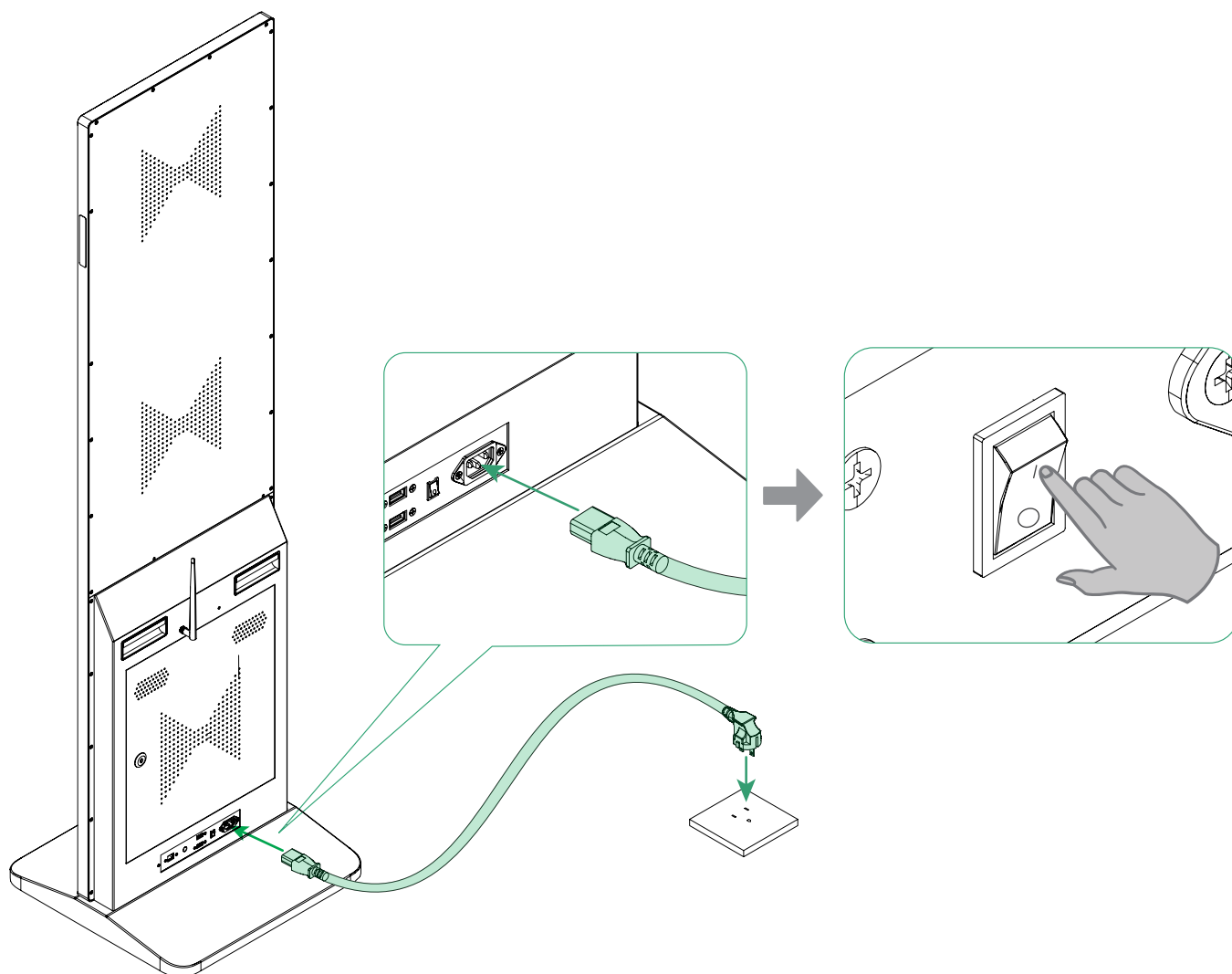
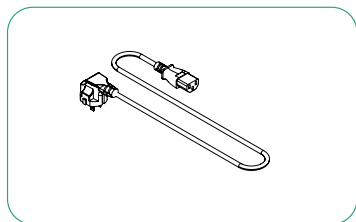



Scansionare il codice QR o visitare il link fornito per imparare come usare il prodotto con le macchine xTool per la lavorazione.



support.xtool.com/article/2087

XTOOL